

1 SOUTH ELEVATION  
SCALE: 3/32" = 1'-0"



2 NORTH ELEVATION  
SCALE: 3/32" = 1'-0"

**MATERIAL LIST**

- 1. HARDIE BOARD SIDING
- 2. COMPOSITE TRIM
- 3. PENNSYLVANIA FIELD STONE CLAD WALLS
- 4. ANDERSEN 400 OR EQUAL WINDOWS AND DOORS
- 5. STAINLESS STEEL CABLE RAIL
- 6. HARDIE SHINGLE

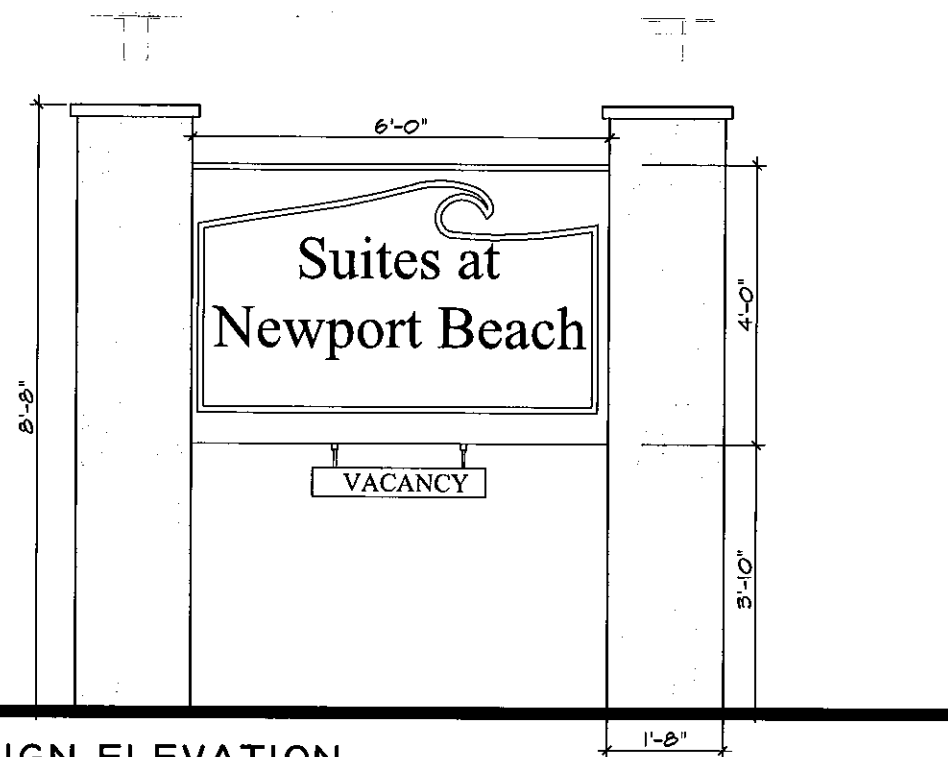

3 SIGN ELEVATION  
SCALE: 1/2" = 1'-0"

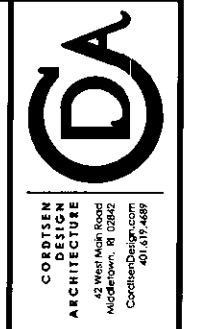

ZONING  
SUBMISSION

REVISIONS:

DESCRIPTION:	PROPOSED ELEVATIONS
SCALE:	AS NOTED
DATE:	December 14th, 2017

BEACH HOTEL ADDITION  
One Wave Ave  
Middletown, Rhode Island

A2.0

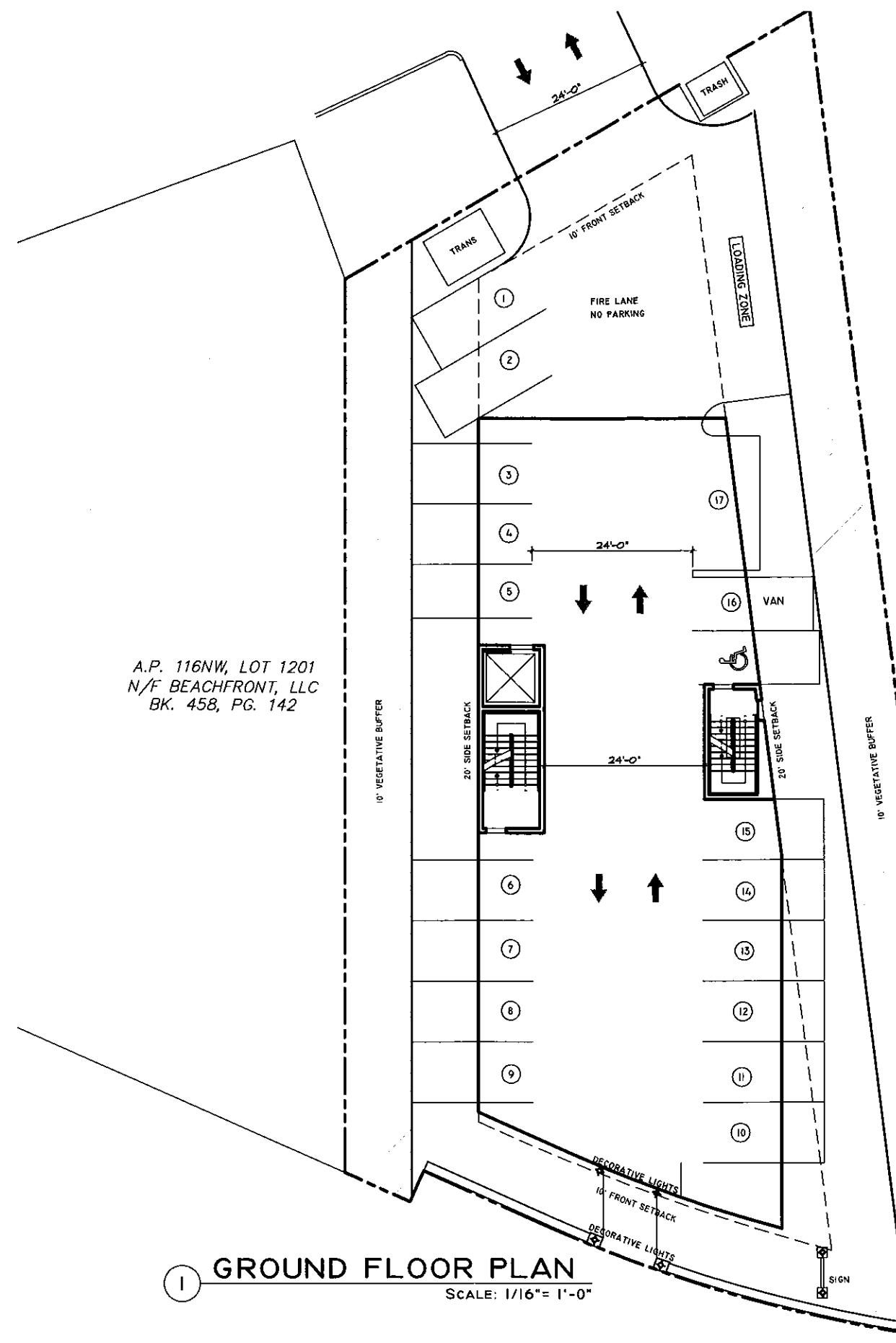

A.P. 116NW, LOT 1201  
 N/F BEACHFRONT, LLC  
 BK. 458, PG. 142

**MIDDLETOWN ZONING:**  
**ZONING DISTRICT:** LBA (LIMITED BUSINESS TRAFFIC SENSITIVE)  
**ZONING USE:** HOTEL (SPECIAL USE PERMIT REQUIRED)

**YARD SETBACKS, MINIMUM REQUIRED:**  
 10'-0" FRONT  
 50'-0" REAR  
 20'-0" SIDES

**YARD SETBACKS, PROPOSED:**  
 10'-0" FRONT  
 50'-0" REAR  
 20'-0" SIDES

**BUILDING HEIGHT, MAXIMUM ALLOWED:** 40'-0" FROM AVERAGE  
 NATURAL GRADE (8'-0") = 48'-0" ALLOWED  
**BUILDING HEIGHT, PROPOSED:** 37'-0"

**MINIMUM LOT SIZE:** 20,000 SF

**LOT COVERAGE, ALLOWED:** 35% OF 13,747 SF = 4,811 SF  
**LOT COVERAGE, PROPOSED:** 4,811 SF = 35%

**ROOMS ALLOWED:** 13,747 / 1000 = 13 TOTAL  
**PARKING REQUIRED 13+4 = 17**

① **GROUND FLOOR PLAN**  
 SCALE: 1/16" = 1'-0"



**ZONING  
 SUBMISSION**

REVISIONS:

DESCRIPTION:	PROPOSED FLOOR PLANS
SCALE:	1" = 20'-0"
DATE:	December 14th, 2017

**BEACH HOTEL ADDITION**  
 One Wave Ave  
 Middletown, Rhode Island

**A1.0**

THIS DOCUMENT IS NOT TO BE USED FOR ANY OTHER PROJECTS WITHOUT THE WRITTEN PERMISSION OF CORDTSEN DESIGN ARCHITECTURE, INC.